

### HCP139403 TYPE

#### TYPE

#### HCP 139403

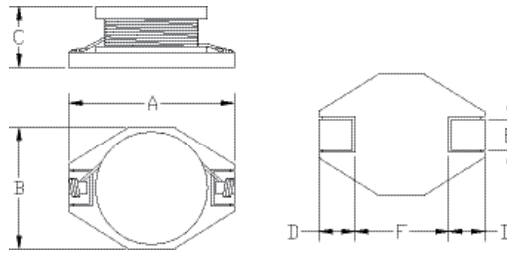

A: 12.95 MAX  
B: 9.4 MAX  
C: 3.0 MAX  
D: 2.54  
E: 2.54  
F: 7.62

#### SPECIFICATION

ITEM	L	SRF	DCR	IDC1	IDC2
HCP139403	( $\mu$ H)	(MHz)	MAX.( $\Omega$ )	MAX.(A)	MAX.(A)
100M	10	35.0	0.1	2.4	2.0
150M	15	33.0	0.2	2.0	1.5
220M	22	25.0	0.2	1.6	1.3
330M	33	19.0	0.3	1.4	1.1
470M	47	14.0	0.4	1.0	0.8
680M	68	12.0	0.7	0.9	0.7
101M	100	10.0	0.8	0.7	0.6
151M	150	8.0	1.2	0.6	0.5
221M	220	6.0	1.9	0.5	0.4
331M	330	5.0	2.7	0.4	0.3
471M	470	4.0	4.0	0.3	0.2
681M	680	3.0	5.3	0.2	0.1
102M	1000	2.5	8.4	0.1	0.1

M:  $\pm$ 20%

\* Hong can design any part to your requirements with different inductance.

\* All parameters as this content presented are subject to final specifications both sides confirmed.